

100
GARDEN CITY
PLAZA



100 GARDEN CITY PLAZA

Unparalleled amenities in an unsurpassed location.

- Recently renovated lobbies, corridors and elevators
- Conference facilities and cafeteria
- High speed internet and DSL service
- Easy access to all Nassau County courts
- Floor-to-ceiling windows around the entire perimeter of the building
- Located in close proximity to the Meadowbrook State Parkway, the Northern State Parkway, the Long Island Expressway and four LIRR train stations
- Ample parking available

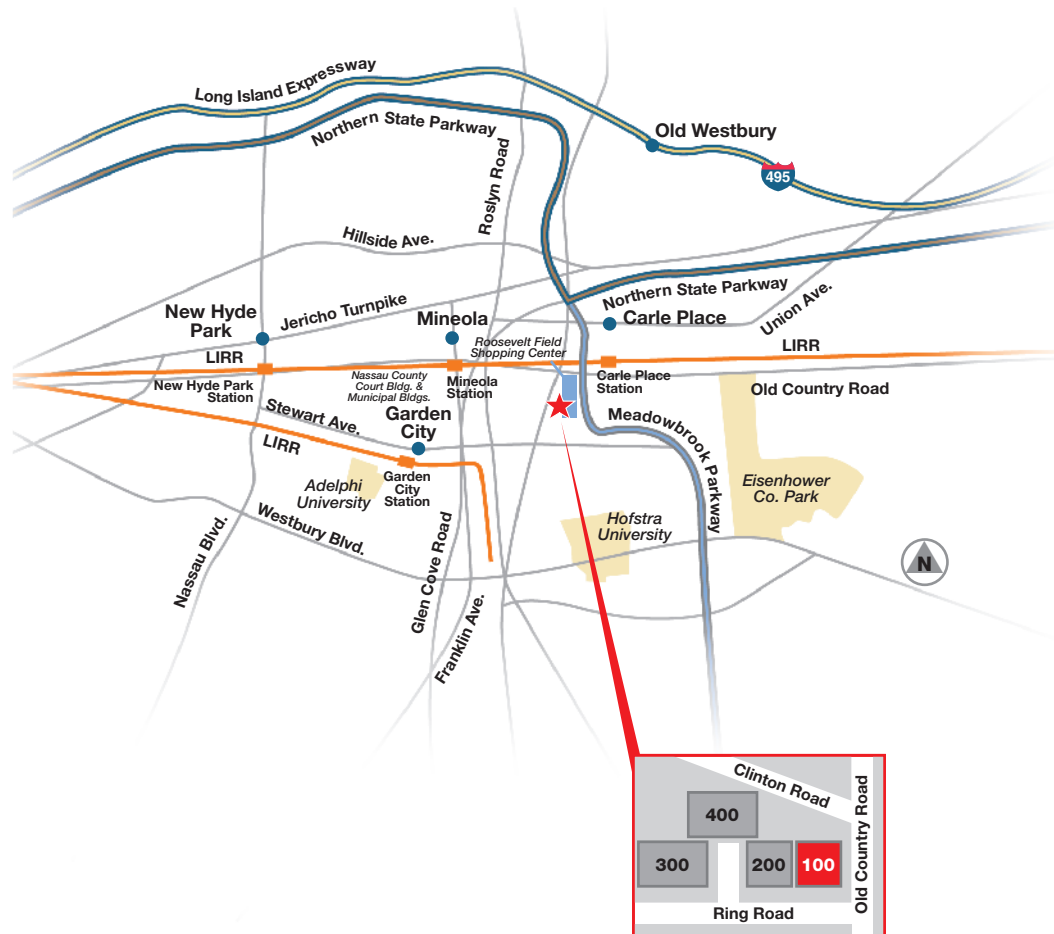

TREELINE

THE TREELINE COMPANIES

For leasing information, please call:

Kraig L. Silver
516.837.8000

WWW.TREELINECO.COM

100 GARDEN CITY PLAZA

Typical floor plan
Approximately 27,000 Square Feet

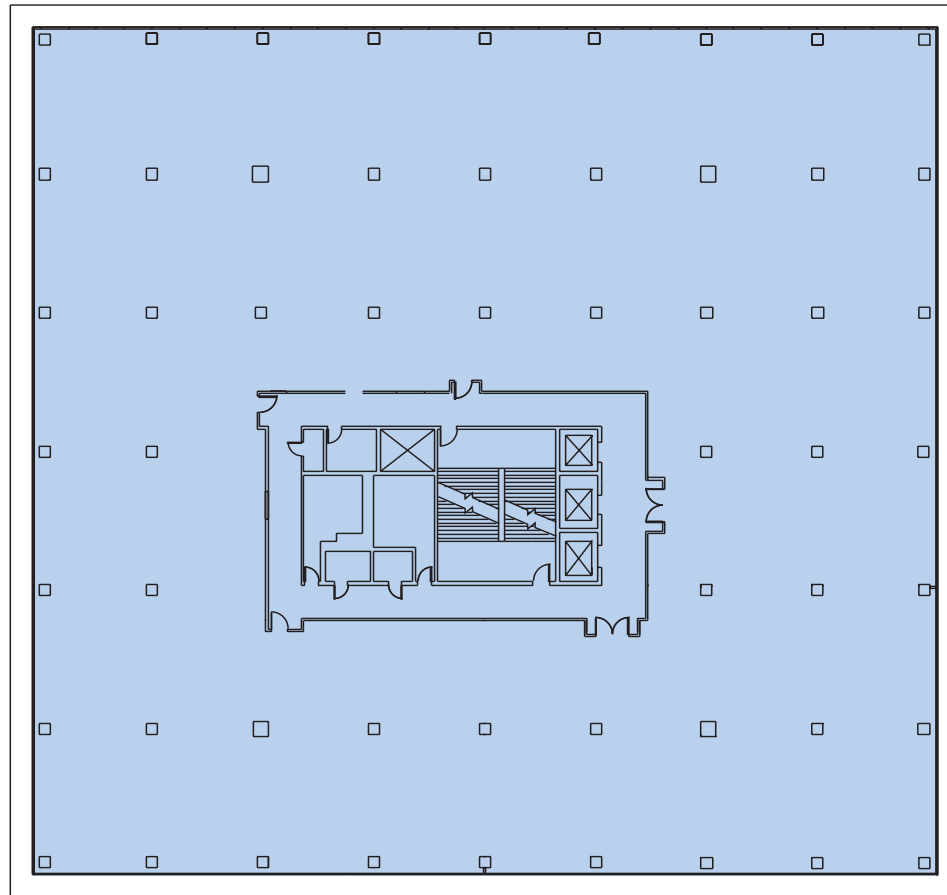

TREELINE

THE TREELINE COMPANIES

For leasing information, please call:

Kraig L. Silver
516.837.8000

WWW.TREELINECO.COM